

Pro2 - How to set the Extruder Tension Properly - V1.0

1. Select the “Load” button of the Left Nozzle on the “Utilities” page.



2. While waiting for the printer to reach the target temperature, remove the guide tube out of the way.

3. Select “Load” and pinch the filament above the extruder assembly.

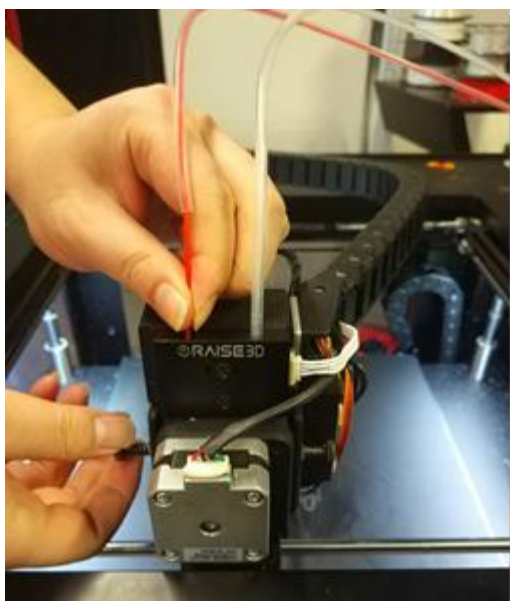

4. Loosen the spring screw until the filament stops loading while continuously pinching the filament.

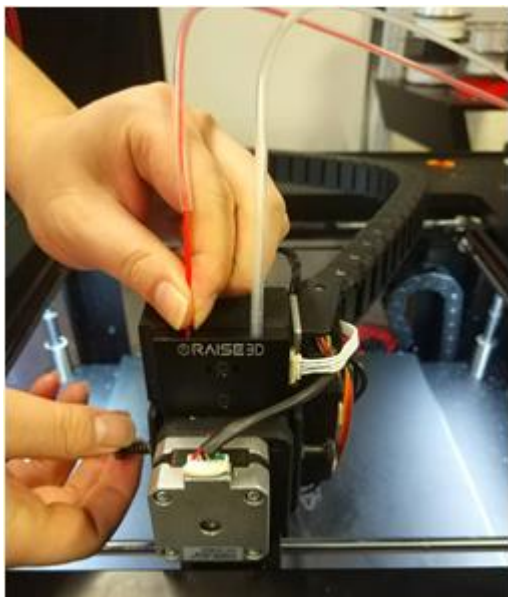

5. Tighten the spring screw until the filament starts loading again, while pinching the filament.
6. Click "OK" on the touchscreen to stop the loading procedure.

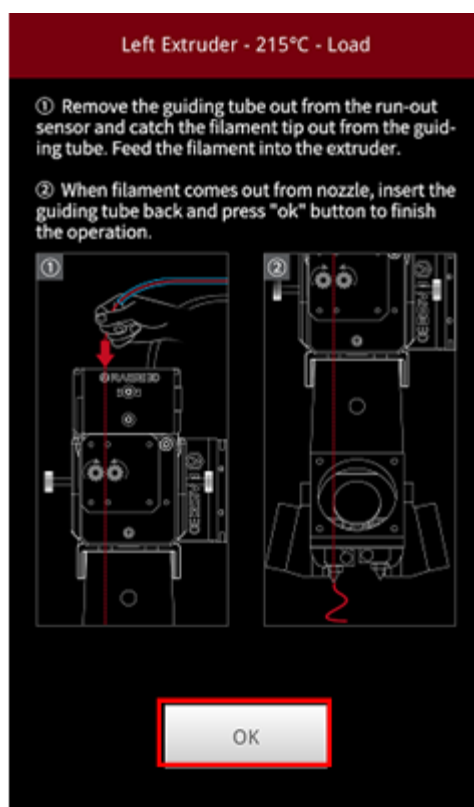

-END-



America | Asia | Europe

Sales & Business: sales@raise3d.com

Technical Support: help.raise3d.com

For any other inquiries: inquiry@raise3d.com